



SOLITEX EXTASANA ADHERO[®]

Wall Application Guide

NZ



AUS



Self-Adhesive Weather Resistive Barrier for Walls and Roofs

Fully adheres to rigid substrates for ultimate protection from wind and driving rain





IMPORTANT

The release film is split into two parts that are 250 mm and 1250 mm wide. The 250 mm-wide application zone is stuck in place first. To ensure that the wider release film can be removed more easily later on, pull off a corner of this film and fold it over. This will then be easier to grip later on.



PRESSFIX XL

A large malleable plastic tool for applying pressure to pro clima SOLITEX EXTASANA ADHERO® to ensure long term durable bonding.



1 Check Substrate

Check substrate to ensure it is even and free from any protrusions, nails, screws etc. This will not be able to be rectified easily after membrane adhesion.



2 Calculate and Mark Guideline

Decide on the position of the first membrane and mark this on the wall. Determine the membrane length.



3 Line the Internal Corners

For interior corners, cut a strip of ADHERO that is at least 400 mm in width and adhere it in place with equal length on each of the walls.



4 Line the External Corners

If necessary, repeat for exterior corners using a strip at least 400 mm in width and adhere it in place with equal length on each of the walls.



5 Cut Membrane and Roll Out

Cut the membrane to required length. Markings make your work easier. Roll up the cut strips such that the release film faces outward.

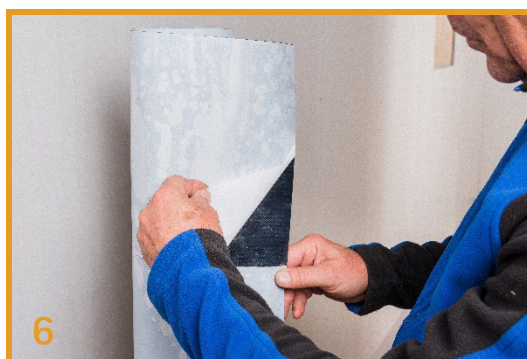

6 Remove Split Release Film

The 250 mm-wide application zone is stuck in place first. Pull off a corner of this film and fold it over. This will then be easier to grip later.

SYSTEM

Weather Resistive Barrier

Wall



IMPORTANT

Air bubbles and voids should be avoided during application by using the PRESSFIX XL to smooth the SOLITEX EXTASANA ADHERO® into place working progressively along the membrane.

In some cases if the substrate material heats up in the sun it is possible that the substrate off gases causes small bubbles to appear even through the membrane was installed smooth. This does not affect the functionality, longevity or durability of the product.



Apply Membrane to Align with Internal Corner
Remove approx. 200 – 300 mm of the release film of the upper application zone. Position the membrane at the marking (on the wall) and attach to the wall.

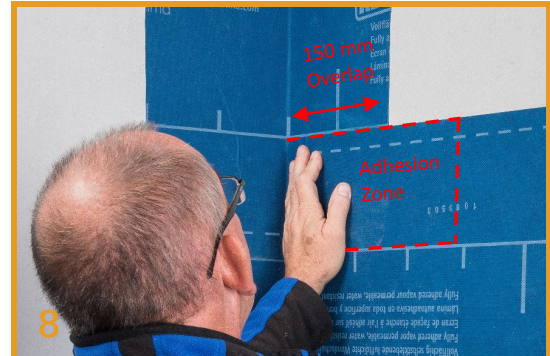

Overlap Corner Strip
Adhere only the 200 – 300 mm released part of the application zone. Ensure that the membrane covers at least 150 mm of the corner strip.

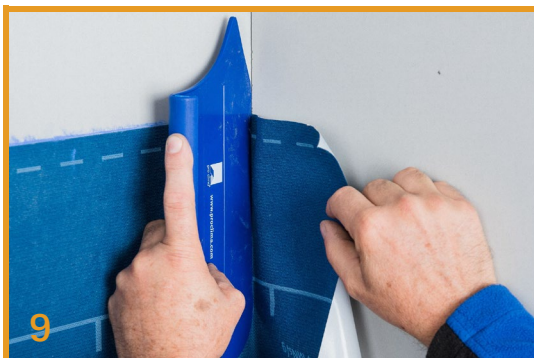

Apply Membrane Without Internal Corner
To form the corner, guide at least 150 mm of the membrane around the corner. Apply pressure and smooth ADHERO using PRESSFIX XL.



Apply Membrane Without External Corner
Wrap SOLITEX EXTASANA ADHERO® at least 150 mm around external corners. Apply pressure and smooth ADHERO using PRESSFIX XL.



Roll Out the Membrane
Continue rolling out the first membrane aligning with the marked line. Gradually remove the release film of the application zone and adhere in place.



Adhere the Entire Section
Smooth the membrane into place using PRESSFIX XL adhering the membrane to the substrate, avoiding air bubbles and folds. Apply pressure for good adhesion.



IMPORTANT

TESCON EXTOSEAL® installation video is available below.



TESCON EXTOSEAL® APPLICATION



Overlap Membrane Layers

Apply all the remaining membranes – one by one – horizontally in an overlapping, waterproof manner. The minimum horizontal and vertical overlap for membranes is 150 mm.



Alternative: Vertical Application

Attach ADHERO at the highest point. Gradually remove the release film by pulling them downward. Apply pressure using PRESSFIX XL.

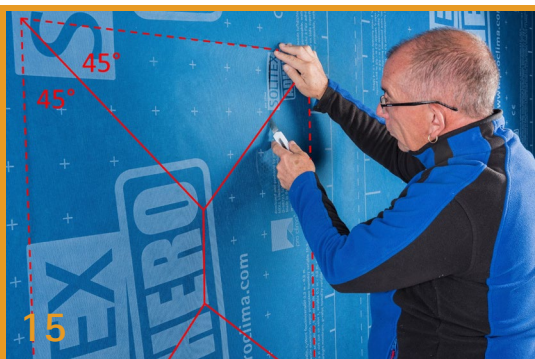

Cut Out Window Openings

When the membrane is adhered over any window openings. To cut out the opening, cut the membranes as indicated with the red line using a knife.



Stick Membrane to Reveal

Once ADHERO has been cut out, fold it onto the reveal and adhere it in place. Smooth the membrane firmly into place using PRESSFIX XL.



Fold All Laps into The Reveal & Adhere

Fold all flaps into the reveal & smooth the membrane firmly into place using PRESSFIX XL.

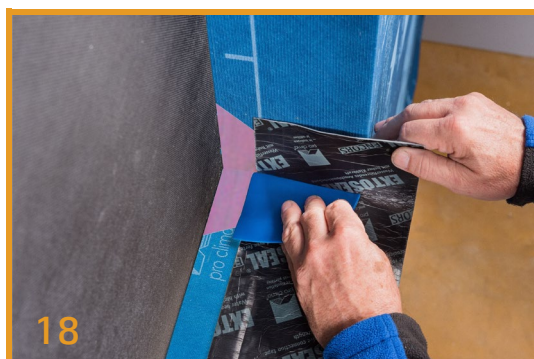

Apply Sub Sill Flashing – TESCOX EXTOSEAL®

TESCON EXTOSEAL® Sill Tape should extend minimum 150 mm up the jambs. Using PRESSFIX on TESCOX EXTOSEAL®, press the corners into place. Refer to the TESCOX EXTOSEAL® Application Guide.

SYSTEM

Weather Resistive Barrier

Wall



IMPORTANT

Avoid hollows or bubbles in TESCON EXTOSEAL® by using PRESSFIX. Stretch the tape sufficiently in the corners and adhere in place in a manner free of tension. Too much tension can result in pull back over time.

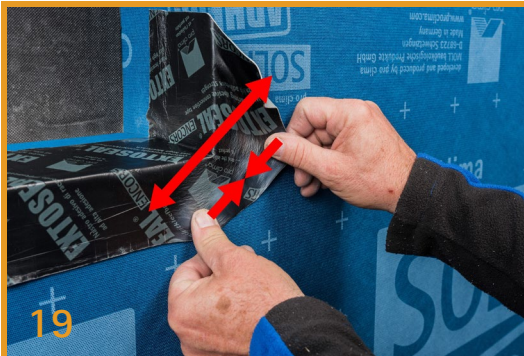
**TESCON EXTOSEAL® – Corner Application**

Adhere the 50 mm release strip to face assuring no tearing has occurred. Refer to the TESCON EXTOSEAL® Application Guide.

**Seal Exposed Framing at Top Corners**

TESCON EXTOSEAL® pieces extending min 200 mm in either direction shall be adhered over the top corners.

**Connect to Foundation**

When sealing to rough substrates like concrete, apply a bead of ORCON® CLASSIC at a thickness of at least 5 mm. Do not press the adhesive completely flat.

**Repair Abrasions Using TESCON EXTORA®**

Adhere TESCON EXTORA® tape overlapping onto undamaged membrane by at least 30 mm. Smooth adhesive joints firmly using a PRESSFIX.



PRESSFIX is a malleable plastic tool for applying pressure to pro clima Adhesive TESCON® Tapes to ensure long term durable bonding.



ORCON® CLASSIC
A durable airtight sealing glue suitable for bonding all pro clima products to any building material, smooth or rough, masonry or timber.



KAFLEX mono/duo
Airtight sealing grommets made of strong and flexible EPDM with adhesive flange for ease of installation.

**Repair Using SOLITEX EXTASANA ADHERO®**

As an alternative, defects can also be repaired by adhering a piece of ADHERO onto them. Smooth adhesive joints firmly using a PRESSFIX.

**Sealing Cable Penetrations**

Place a KAFLEX sealing grommet over round cables and adhere it to the membrane. Smooth adhesive joints firmly with a PRESSFIX.



25

Sealing Pipe Penetrations
 Select the correct sized ROFLEX grommet and adhere to the subsurface using TESCON EXTORA® tape. Ensure unders and overs are in a diamond pattern then smooth adhesive joints firmly with a PRESSFIX.



26

Rafter / Joist / Beam Connections
 Seal angular penetrations using TESCON EXTORA® PROFIL tape. Smooth adhesive joints firmly with a PRESSFIX.



27

Screw / Nail Sealing
 If brackets or similar parts are to be attached to the wall, use TESCON EXTASEAL® patches or TESCON® NAIDECK for nail/screw sealing.



28

Additional Technical Information
<https://proclima.com.au/solitex-extasana-adhero/>
<https://proclima.co.nz/solitex-extasana-adhero/>



TESCON EXTORA®
 Pressure sensitive adhesive tape for overlaps and end laps in SOLITEX EXTASANA® system.



TESCON EXTASEAL®
 Flexible flashing tape for use around window and door openings as part of the SOLITEX EXTASANA® system.



TESCON® NAIDECK
 Is double-sided self-sealing strip, design to seal penetrations of purlins, battens or studs.

Continue to the next page for the Adhesion Matrix and further recommendations.



ROFLEX
 Sealing grommet made of strong and highly flexible EPDM for rapid and permanent airtight feedthroughs for pipes.

SYSTEM

Weather Resistive Barrier

Wall



SOLITEX EXTASANA ADHERO® Adhesion Matrix

IMPORTANT

TESCON® PRIMER RP is a primer that penetrates into the sub-surface of porous substrates locking up loose particles and creating a highly adhesive substrate for the SOLITEX EXTASANA ADHERO® to be applied. SOLITEX EXTASANA ADHERO® can be applied while the TESCO® PRIMER RP is still tacky or fully dry.

ORCON® CLASSIC is required when sealing to uneven masonry surfaces and can be applied over surfaces prepared with TESCO® PRIMER RP.



TESCON® PRIMER RP

Applied to substrates to prepare for optimum adhesion such as concrete, masonry, timber, fibre cement, plywood, oriented strand board (OSB), and other porous or friable surfaces prior to application of TESCO® EXTORA®.

		SOLITEX EXTASANA ADHERO	TESCON EXTORA®	TESCON EXTORA® PROFIL	TESCON EXTOSSEAL®	ORCON® NAUDECK	CONTEGA® CLASSIC	KAFLEX mono/duo	KAFLEX post	ROFLEX	DUPLEX	TESCON® PRIMER RP
Timber, OSB, Plywood	dirty			✓								✓
	clean	✓	✓	✓	✓	✓						✓
Plaster board	clean	✓	✓	✓	✓		✓					✓
Paint primers		✓	✓	✓	✓		✓	✓				✓
AEROSANA® VISCONN	dry / clean	✓	✓	✓	✓		✓	✓	✓	✓	✓	✓
PIR Polysiocanurate	on foil	✓	✓	✓	✓		✓	✓	✓	✓		✓
	on PIR											
XPS Extruded Polystyrene	clean	✓	✓	✓	✓		✓	✓	✓	✓		✓
EPS Expanded Polystyrene	clean	✓	✓	✓	✓		✓	✓	✓	✓		✓
Expanding foams	dry											
Cement/Gypsum plaster	smooth	✓	✓	✓	✓		✓	✓	✓	✓	✓	✓
	rough						✓					✓
	friable											✓
Acrylic plaster	smooth	✓	✓	✓	✓		✓	✓	✓	✓	✓	✓
	rough						✓					✓
Steel	galvanized	✓	✓	✓	✓		✓					✓
	bright	✓	✓	✓	✓		✓					✓
	painted	✓	✓	✓	✓		✓					✓
Aluminium	clean	✓	✓	✓	✓		✓					✓
Brickwork	rough						✓					✓
	friable											✓
Dampcourse	aluminium						✓					✓
	polyethene						✓					✓
Chemical tremite barrier	blue	✓	✓	✓	✓		✓					✓
	orange	✓	✓	✓	✓		✓					✓
Concrete	smooth	✓	✓	✓	✓		✓	✓	✓	✓		✓
	rough						✓					✓
Fibre cement	clean	✓	✓	✓	✓		✓	✓	✓	✓	✓	✓
	friable											✓
Window Frames	aluminium	✓	✓	✓	✓		✓	✓				✓
	PVC	✓	✓	✓	✓		✓	✓				✓
	timber	✓	✓	✓	✓		✓	✓				✓
Cables	flat	✓	✓	✓	✓		✓		✓			
	round	✓	✓	✓	✓		✓		✓			
Pipes / ductings		✓	✓	✓	✓		✓			✓		

Notes:

- Surface should always be dry.
- TESCO® PRIMER RP is always recommended for mineralic surfaces.

pro clima SOLITEX EXTASANA ADHERO® Adhesion Matrix

SOLITEX EXTASANA ADHERO® is compatible with all pro clima Adhesive Tapes and Sealants. Optimum weatherproofing is achieved when wind tight connections are made between SOLITEX EXTASANA ADHERO® and other building materials and components. The table above provides guidance on the use of pro clima Adhesive Products when used to connect the SOLITEX EXTASANA ADHERO® system with other common building materials.



Recommendations and requirements

- SOLITEX EXTASANA ADHERO®, TESCON EXTORA® and TESCON EXTONSEAL® form a continuous system. Any damage or tears should be patched.
- SOLITEX EXTASANA ADHERO® when used over a rigid substrate may be used as a temporary weather protection to allow the internal lining of framed buildings to proceed before the wall cladding is installed.
- Any staples, damage, penetrations, or mechanical fixings used during installation may limit SOLITEX EXTASANA ADHERO® as temporary weather protection. Use of TESCON EXTORA®, TESCON EXTONSEAL® patches or TESCON® NAIDECK can maintain the performance of SOLITEX EXTASANA ADHERO® for temporary weather protection.
- SOLITEX EXTASANA ADHERO® has up to 180 days UV exposure limit prior to cladding.

Certification

Declare.



NZ ONLY



Your local support

NEW ZEALAND
0800 PRO CLIMA (776 254)
Technical: support@proclima.co.nz
General: welcome@proclima.co.nz
www.proclima.co.nz

AUSTRALIA
1800 PRO CLIMA (776 254)
support@proclima.com.au
welcome@proclima.com.au
www.proclima.com.au

